



Overview

The AlcoMate Pro Model CA2000 is a breath alcohol screening device designed to test for the presence of alcohol in human breath. This device is intended to be used in all populations with lungs capacity capable of producing at least 1.5 liters of exhaled air. The AlcoMate Pro is powered by a 9 volt alkaline battery that generally lasts between 200-300 tests.

Preparing For Use

Install a 9-volt alkaline battery. To release the cover, apply a small amount of pressure on the indentation of the battery compartment cover and then push down and away from the unit simultaneously. Install the battery and replace the battery compartment cover. (See the following diagram).

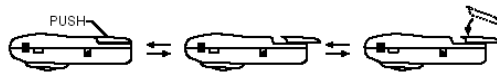

The tester comes with one replaceable plastic mouthpiece already mounted over the breath pipe. You may wish to replace the mouthpiece for use by another person for sanitary reasons. To change the mouthpieces, align the slot in the mouthpiece with the slot on the BREATH PIPE.

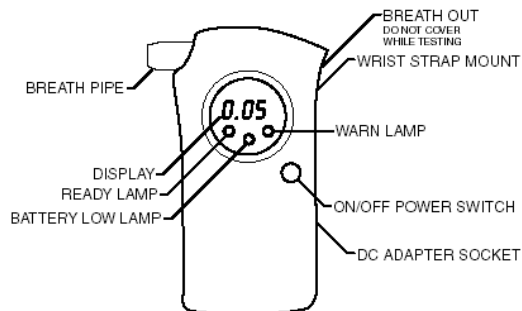

How to Test?

ALWAYS WAIT AT LEAST 20 MINUTES FROM YOUR LAST DRINK- BEFORE TESTING

If you do not wait, all future readings may be inaccurate.

1. Press the ON/OFF power switch. The detector will start to count down from 200 to 000. The warm up and cleaning cycle will prepare the sensor for testing.
2. After hearing a BEEP and the green READY light comes on, take a deep breath, then gently and steadily blow into the breath intake until you hear the second BEEP. You will blow for 4.5 seconds. Make sure your lips are sealed around the pipe and your hand has not covered the air outlet.
3. After the red and green display lights blink for 4 seconds, the test results will be displayed by 3 digits and remains on for 15 seconds.
4. If you don't blow within 30 sec from the READY, the unit will time out and displays a blinking "OFF". Press the ON/OFF power switch to turn the unit off and repeat step 1.

How to Analyze the Results?

- If the BAC reading is over 0.05%, the red WARN lamp will flash along with a BEEP sound.
- If the BAC reading is over 0.4%, the display reads "HOT" and the red lamp will flash along with the BEEP sound. This can also occur if a subject blows alcohol from their saliva into the tester.
- If you consume very little alcohol, your actual alcohol concentration may be below .01% BAC and the device may not be activated. However, the display will read 0.00% until 30 seconds to time out.

Precautions

1. **Always wait at least 20 minutes after your last drink- before testing.** Why? Because it can take up to 20 minutes for any residual alcohol in the mouth to dissipate and for alcohol to be fully absorbed in the blood.
2. Avoid testing in strong winds, in a closed room with a heavy smoke, or where a lot of alcohol is being consumed (crowded bars).
3. When the battery low light is glowing, replace the battery.
4. Do not blow cigarette smoke, food or liquid into the instrument
5. AlcoMate Pro is designed for use in a temperature range of 10 – 40 (C) or 50-104 (F). Operation of the unit in extreme temperatures outside this range may affect the readings accuracy.
6. Do not leave AlcoMate Pro connected to an external power source when it is not in use.
7. Avoid testing in the presence of any substances that may contain methyl alcohol, isopropyl alcohol or acetone. These substances may interfere with the results of the test.
8. Conditions that increase the amount of ketones on the breath, such as diabetes and low caloric intake, may cause a false positive test.
9. **DO NOT DRINK AND DRIVE. ALWAYS HAVE A DESIGNATED DRIVER WHEN YOU CONSUME ALCOHOL**

Verification and Calibration Overview

Verification is a procedure using an Advanced Alcohol Breath Test Simulator that verifies whether the unit is displaying the specific BAC level. If the verification procedure determines that the BAC is not consistent with actual BAC levels, calibration of the device is performed. A breath alcohol screening device can start to drift or become contaminated after 6–12 months, depending on frequency of use and whether alcohol or other substances penetrate the sensor.

Disposable Mouthpieces

Your detector is equipped with removable / disposable mouthpiece. For all sanitary considerations replace and dispose the mouthpiece when testing others. To reorder please visit our online store or call our order desk.

Calibration Procedure

If your device is providing inconsistent, unusually high or low readings, or no readings at all, your device may need to be re-calibrated. In addition, the AlcoMate Pro should be re-calibrated at least every 6-12 months. More frequent calibrations may be required depending on frequency of use. For detailed information on how to have the device re-calibrated, please visit us online at:

www.safety-devices.com/calibration.htm

Cleaning

Although it may seem logical to clean your device with alcohol or other cleaning agents, but in reality, this is a very harmful to the device sensor. All semiconductor sensors are very intolerant to high dozes (saturation level) of alcohol, and other cleaning or anti bacterial agents.

To keep your device in sanitary condition, always discard the mouthpiece if test has been performed by other than yourself.

Technical Specifications

Dimensions	120x60x25 mm/4.7x2.4x1"
Battery	9V Alkaline
Sensor	Highly Selective Semiconductor
Response Time	3.0 Seconds
Calibration	BAC Simulator
Weight	200 Grams /1.5 OZ
Operating Temp.	10-40 C / 50-104F
Warm-up Time	20 Seconds
Accuracy	+/- 0.01% BAC at.10% BAC
Calibration Interval	Every 6 - 12 Months

Dose-Specific Effects of Alcohol Intoxication

0.02-0.03%	Generally no loss of coordination, slight euphoria or loss of shyness. Depressant effects are not apparent.
0.04-0.06%	General feeling of well-being, relaxation, lower inhibitions, sensation of warmth. Euphoria. Some minor impairment of reasoning and memory, lowering of caution. Driving skills may be impaired at this level of intoxication.
0.07-0.09%	Slight impairment of balance, speech, vision, reaction time, and hearing. Euphoria. Judgment and self-control are reduced, and caution, reason and memory are impaired. Driving skills are always impaired at this level of intoxication.
0.10-0.125%	Significant impairment of motor coordination and loss of good judgment. Speech may be slurred; balance, vision, reaction time and hearing will be impaired. Euphoria
0.13-0.15%	Gross impairment and lack of physical control. Blurred vision and major loss of balance. Euphoria is reduced and dysphoria is beginning to appear
0.16-0.20%	Dysphoria (anxiety, restlessness) predominates, nausea may appear. The drinker has the appearance of a "sloppy drunk."
0.25%-0.29%	Needs assistance in walking; total mental confusion. Dysphoria with nausea and some vomiting.
0.30%-0.39%	Loss of consciousness.
0.4%BAC	Loss of consciousness and possible death

Warranty

The manufacturer warrants the AlcoMate Pro to be free from defects in workmanship or material (excluding calibration) under normal use for one year from the date of purchase. Manufacturer's obligations under this limited warranty are limited to replacing, adjusting, or repairing the unit if returned along with the proof of purchase. This warranty is void if the unit has been tampered with, maliciously damaged, or physically abused. The enforceability of this warranty is limited to the original consumer purchaser and is not transferable to, or enforceable by, any subsequent owner. In the event of a defect, malfunction or other failures conforming to this warranty, ASD, LLC, will at its sole discretion, repair or replace the unit. You are responsible for all shipping cost in connection with warranty service. This warranty commences on the date of purchase and shall be effective for a period of one year.

This warranty gives you specific legal rights, and you may also have other rights which vary from state to state.

If you purchased your device directly from Advanced Safety Devices, please send email to: service@safety-devices.com otherwise, please contact your place of purchase

Disclaimer

Advanced Safety Devices, LLC makes no warranties, expressed or implied, as to the ability of this device to determine whether a person is intoxicated, and ASD expressly disclaims any liability for incidental, special, or consequential damages of any nature. Decisions and/or actions based upon the reading of this device shall be at such person's own risk. ASD assumes no responsibility for consequences of subjects who test negative when using this device and later show that they are under the influence of alcohol or their judgment has been impaired by alcohol. This device should only be used as a screening device and may only give an indication of the possible presence of alcohol in the blood of the test subject. Correlation between breath alcohol content and blood alcohol concentration depends on many variables, including temperature and health conditions. A safe or low BAC reading on a breath alcohol screener does not mean that the driver's reaction times can respond to any emergency encountered. The exact concentration of alcohol in the blood of the test subject cannot be exactly determined by using a breath alcohol screening device.

Customer Care

If you have questions about Advanced Safety Devices products or services, please contact us via telephone, e-mail or mail. Our knowledgeable customer service agents will gladly assist you in any way they can.

Calibration: <http://www.safety-devices.com/alcomatapro.htm>

Telephone: 1-818-701-9200 between 8:00 AM and 5:00 PM PST, Monday - Friday.

E-mail
service@safety-devices.com

Mail
Advanced Safety Devices, LLC.
9140 Jordan Ave
Chatsworth, CA 91311

Website:
<http://www.safety-devices.com>