

1

WHAT'S INCLUDED

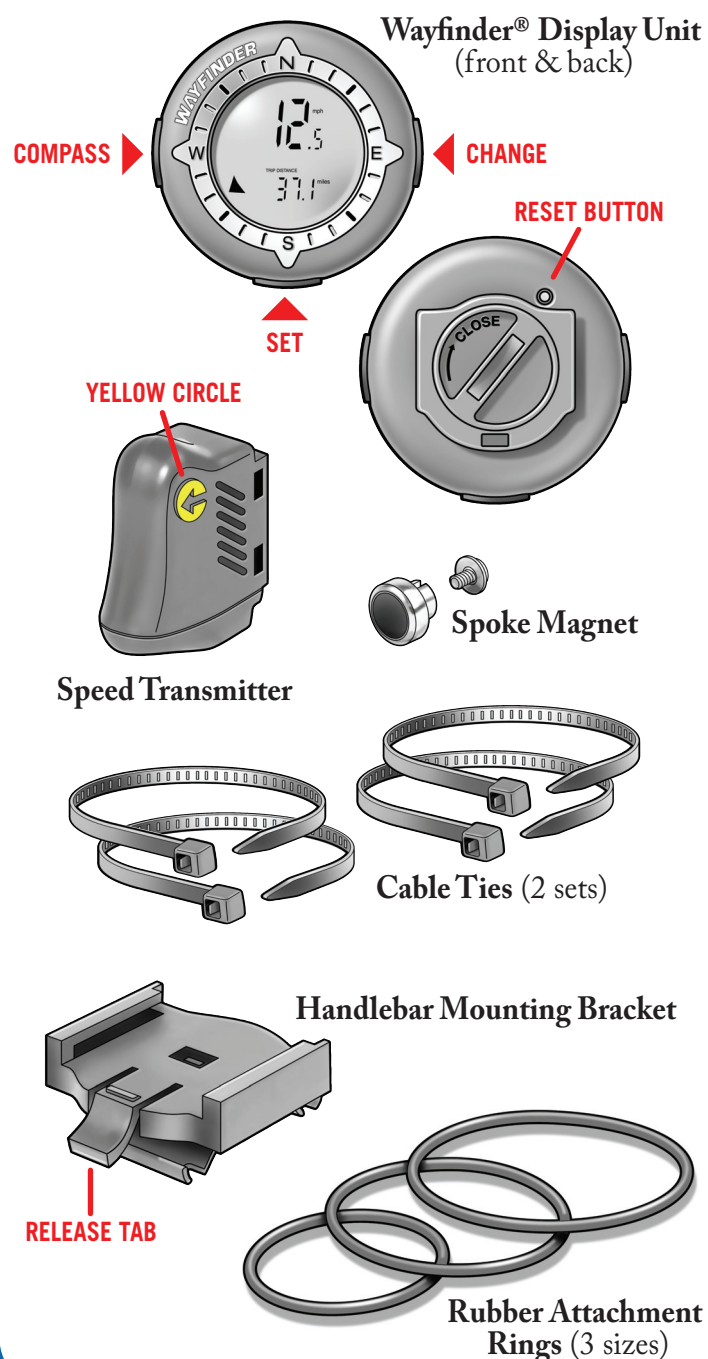

2

HOW TO INSTALL

To install the Wayfinder Bike Speedometer, you need to mount 3 key components on your bike: the **Display Unit** (which mounts on your handlebar), the **Speed Transmitter** (which mounts on your bike fork) and the **Spoke Magnet** (which mounts on your front wheel spokes). Decide whether you want them installed on the right or left side of your bike.

A) Attach the Speed Transmitter

- I. Insert cable ties through the Speed Transmitter.
- II. Attach the Speed Transmitter to the inside of the RIGHT bicycle fork (as viewed when seated on the bike), as high up on the fork as possible.

a. Be sure the curved front of the Speed Transmitter is **DIRECTLY FACING** the wheel spokes, with the **yellow circle** on the Transmitter **FACING BACK TOWARDS** THE BICYCLE SEAT.

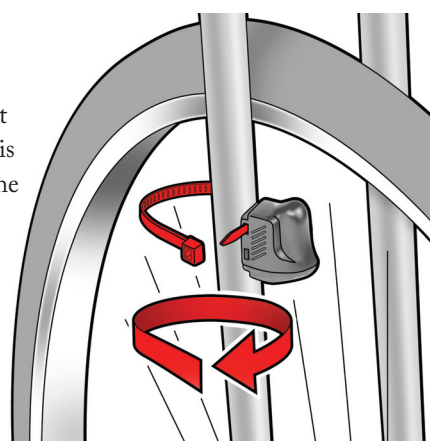

b. Wrap the cable ties around the fork and insert the tail ends through the flat side of the head.

c. Secure the cable ties **LOOSELY** as you may need to further adjust the Transmitter.

B) Attach the Spoke Magnet

1. **Screw the Spoke Magnet** to a spoke directly across from the Speed Transmitter, making sure the flat surface is **DIRECTLY FACING** the Transmitter.

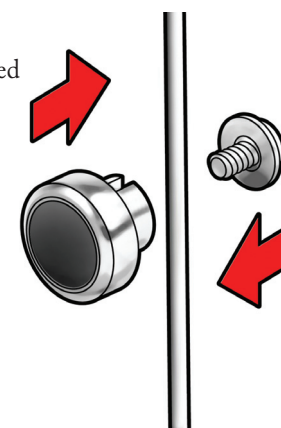

a) **Be sure there is no more than 1/6" of space (the thickness of a quarter) between the Magnet and the Transmitter. THIS IS VERY IMPORTANT.**

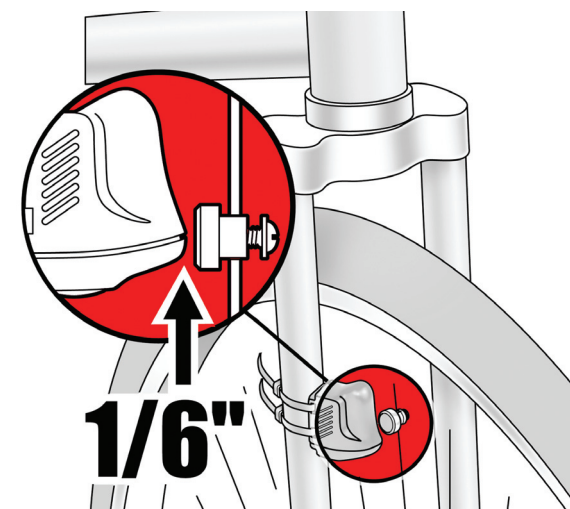

b) **Spin your bicycle wheel** to check the distance between the Transmitter and Magnet. The Spoke Magnet should pass directly in front of the Speed Transmitter as the wheel turns.

2. **Secure the Transmitter** by cinching the cable ties. Clip off loose ends.

C) Attach Mounting Bracket to Handlebar

I. **Locate the spot on the handlebar** that is directly above the Speed Transmitter.

NOTE: If the Speed Transmitter is located on the bike's **RIGHT** fork, then select the area directly over the Transmitter on the right side of the handlebar. If you wish to place the Display Unit on the **LEFT** handlebar, then the Speed Transmitter must be attached to the **LEFT** bike fork and the Spoke Magnet must face the **LEFT** fork.

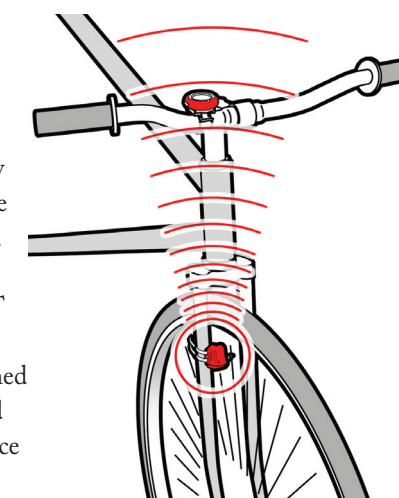

II. **Peel the tape shield** off the back of the bracket.

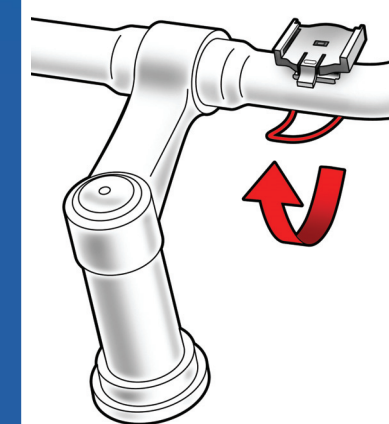

III. **Adhere the Mounting Bracket to the handlebar** so that the Release Tab faces the bicycle seat, keeping the bracket as level as possible.

IV. **Slip an appropriate-sized Rubber Attachment Ring over the hook** on one side of the Bracket. Then stretch it under the handlebar and attach to the hook on the other side.

D. Slide Wayfinder® Display into Bracket

I. Slide the Wayfinder into the receptacle on the Mounting Bracket. You will feel or hear a "click" when it is fully inserted.

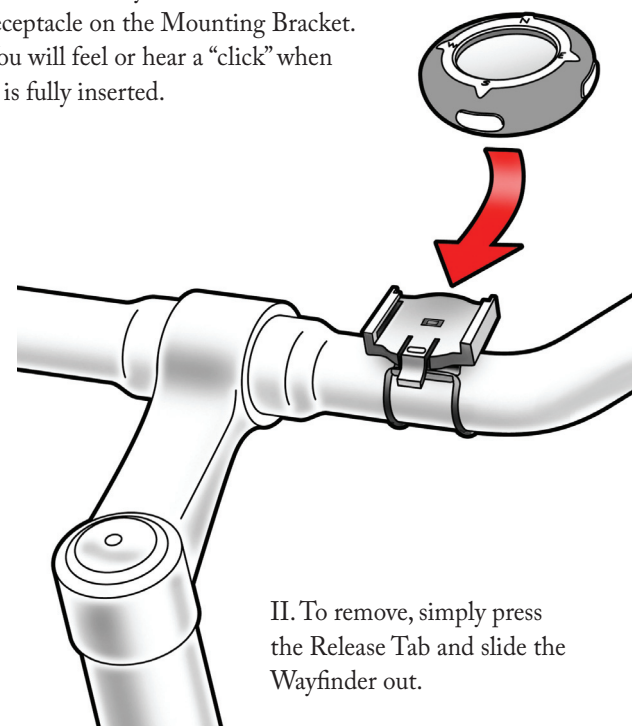

II. To remove, simply press the Release Tab and slide the Wayfinder out.

E. Confirm Signal is Sending and Receiving

- I. Press any button on the Wayfinder display to activate.
- II. Spin the front wheel, and confirm the display is receiving a signal. If it is not, check to see that:
 - a) The Spoke Magnet is passing directly in front of the Speed Transmitter;
 - b) The space between the Spoke Magnet and Transmitter is no greater than 1/6" (the thickness of a quarter);
 - c) The display on the handlebar is aligned over the Transmitter.

3

HOW TO OPERATE

A. Turning On the Wayfinder Display

- I. Press any button to turn on the Wayfinder display.
- II. Once on, the Wayfinder automatically registers your speed, trip time and distance as soon as you move your bicycle.
- III. The Wayfinder is water resistant and shock resistant and can be used in rainy weather and across wet terrain.

B. Reading the Display

- I. Remove the plastic overlay from the display face.
- II. The Wayfinder displays:
 - a) The compass direction you're heading in, marked by an arrow that circles the display face as you change direction.
 - b) Your speed in miles per hour (you may change to kilometers, see Changing from Miles to Kilometers).
 - c) Trip Distance or Trip Timer (press the CHANGE button to toggle between these two readings).

C. Resetting the Trip Distance & Trip Timer

To reset the Trip Distance and Trip Timer readings back to zero:

- I. **PRESS AND HOLD** the SET button for 6-7 seconds while the display shows the following message: "HOLD SET TO RESET TRIP".
- II. Release the SET button once the Trip Distance/Trip Timer are reset to zero.
- III. The screen will display the setting previously selected (Trip Distance or Trip Timer).

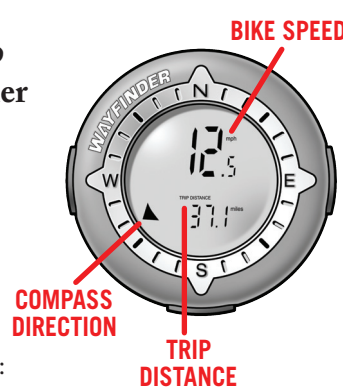

D. Turning Off the Wayfinder

The Wayfinder turns off automatically after 10 minutes with no bike motion.

4

HOW TO REPLACE THE WAYFINDER UNIT BATTERY

The Wayfinder is pre-installed with a lithium battery 2032. Battery life is approximately 500 hours. When the battery is low, the Wayfinder display will become dim or simply not turn on.

To Replace the Battery:

- A. Use a coin to remove the battery cover from the back of the Wayfinder.
- B. Install a new battery with the positive (+) polarity facing out.
- C. Replace the cover and tighten.

NOTE: All stored settings are erased when the battery is changed. You'll need to setup the compass to get accurate readings, reset the Wheel Size, if desired, and change the Miles reading to Kilometers, if desired. See Changing Stored Settings for instructions.

5

HOW TO REPLACE THE SPEED TRANSMITTER BATTERY

The Speed Transmitter is pre-installed with an alkaline battery A23. Battery life is approximately 500 hours. When the Transmitter battery is low, you will not receive any speed, distance or time readings.

To Replace the Battery

- A. Use a coin to remove the battery cover from the top of the Transmitter.
- B. Install a new battery with the positive (+) polarity facing out.
- C. Replace the cover and tighten.

WAYFINDER®

B110 Bike Speedometer with Digital Compass



PNI Corporation

5464 Skylane Boulevard, Suite A
Santa Rosa, CA 95403
USA

T: (888) 422-6672 (Customer Service)
F: (707) 566-2261

www.pnicorp.com

6

CHANGING STORED SETTINGS

A. Setting Up the Compass

The Wayfinder comes with the compass already setup. It should not need to be setup again unless you change the batteries.

I. PRESS AND HOLD the COMPASS button while the screen displays the message "HOLD TO START SETUP".

II. Release the COMPASS button once the screen begins to display "WALK BIKE IN FULL CIRCLE THEN PRESS SET".

III. Walk your bicycle in a small, complete circle. You have 20 seconds to complete the circle. The arrow on the display will rotate around the display face as the compass is being setup.

IV. Press SET to complete. The display will read "DONE" and your compass will now display correct headings.

B. Changing the Wheel Size

The Wayfinder comes with the most common Bicycle Wheel Size (2124 mm) already selected. If you wish to adjust to a specialized wheel size:

I. Look at the sidewall of your bike tire to find the wheel diameter (imprinted on the tire).

II. Use the chart below to find your Wheel Diameter and corresponding Wheel Size.

Bike Wheel Diameter	Type of Bike	Wheel Size (mm)
20"	Common BMX	1569
24" x 1.5 to 2.25	Juvenile Mountain Bike	1888
26" x 13/8	Older Adult Town Bike w Skinny Tire	2073
26" x 1.25	MTB with Street Tire	1953
26" x 1.5	MTB with Street & Dirt Style Tire	2030
26" x 1.75	MTB off road style tire	2045
26" x 2.0, 2.25 & 2.75	MTB or Beach Cruiser with fat tire	2099
650 x 20c	Triathlon, time trial, small road bikes	1945
700 x 25c	Road Racing Bike (default setting)	2124
700 x 28c	Touring or Hybrid Bike	2136
700 x 32	Touring or Cyclocross Bike	2155
27" x Anything	Older Style Road Bike circa 1978 or older	2145

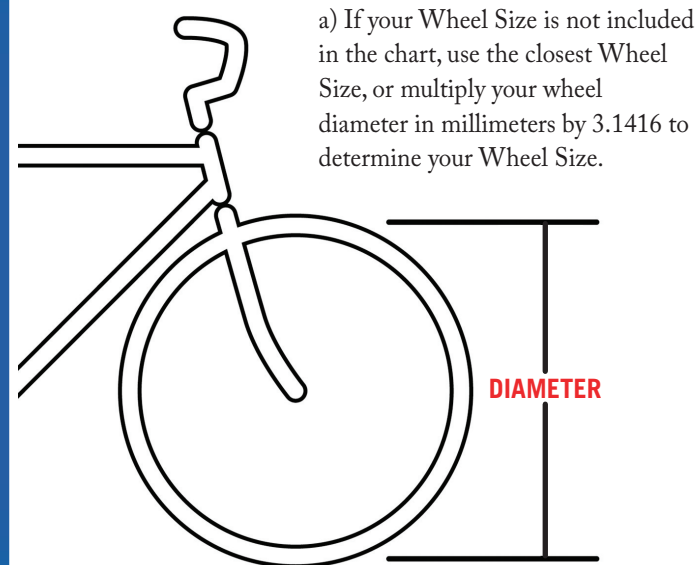

III. Remove the Wayfinder from its bracket and press the RESET button on the back of the unit, using a pen.

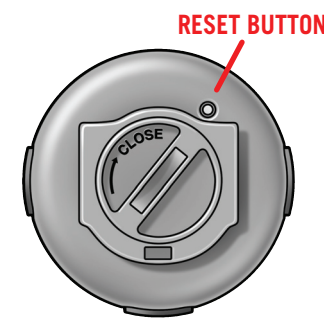

The current Wheel Size will display on the screen, with the last digit flashing.

IV. Use the CHANGE button to change the flashing digit to the correct number for your new Wheel Size.

V. Press the SET button when you've reached the correct digit. The next digit in the series will begin to flash.

VI. Use the CHANGE and SET buttons as needed to change and set the digits to your new Wheel Size.

VII. If an incorrect digit is selected at any point during Wheel Size entry, press the RESET button again to repeat the process from the beginning of the setup mode.

VIII. When you are finished, you will be prompted to reset your MILES or KM selection.

- Press the CHANGE button to toggle between MILES and KMH.
- Press the SET button to set your selection.

C. Changing from Miles to Kilometers

I. Remove the Wayfinder from its bracket.

II. Press the RESET button on the back of the Wayfinder, using a pen tip.

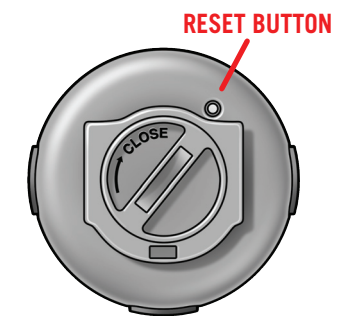

a) The display will first show the Wheel Size information.

b) Press the SET button four times to scroll through the digits of the wheel size number. After the fourth press, the display will show "MILES".

c) Press the CHANGE button to toggle between MILES and KMH.

d) Press the SET button to set your selection.

7

TROUBLESHOOTING

Your Wayfinder B110 is designed to deliver reliable service. If you do encounter a problem, please refer to this section and our website at www.pnicorp.com before contacting Customer Service.

A. The Wayfinder display does not turn on when pressing the buttons.

- Replace the unit battery, following the instructions under How to Replace the Wayfinder Unit Battery.

B. The Wayfinder does not provide accurate compass readings.

- Reset the compass, following the instructions under Setting Up the Compass.

C. The Trip Distance reading does not appear to be accurate.

- Use the Wheel Size Chart to find your wheel size.
- Re-enter the Wheel Size following the Changing the Wheel Size instructions.

D. The speedometer does not appear to provide accurate readings, or provides no reading.

- Check to see that the Speed Transmitter is mounted properly, with the curved front directly facing the wheel spokes.
- Check to be sure your Spoke Magnet hasn't slipped from its location opposite the Speed Transmitter. The Magnet should be no more than 1/6" from the Transmitter (the thickness of a quarter) as it passes in front of it.
- If these are properly in place:
 - Remove the Wayfinder from its bracket, turn the bike over, and spin the front wheel, holding the Wayfinder unit as close to the Speed Transmitter as possible.

2) If the speed starts to register, you may have a proximity problem. Try moving the Speed Transmitter higher up on your bicycle fork.

3) If the speed does not register, replace the Transmitter battery following the instructions under How to Replace the Speed Transmitter Battery.

E. The display shows only one speed and appears fuzzy.

- Check to see that you've removed the plastic display overlay.

8

SERVICE AND REPLACEMENT

If you wish to return your Wayfinder directly to PNI Corporation, contact us between 8:00 a.m. and 5:00 p.m. (PST) Monday through Friday at the following phone numbers or email address. We'll give you instructions for returning your Wayfinder for repair or replacement.

Phone: (707) 566-2260
 Fax: (707) 566-2261
 Email: returns@pnicorp.com

9

SHORT SUMMARY OF LIMITED WARRANTY FOR WAYFINDER® B110

For the Full Warranty and Limitation of Liability applicable to this product, see our Website at www.pnicorp.com, select "Consumer Products" and click "Download".

PNI Corporation ("PNI") manufactures its products from parts and components that are new or equivalent to new in performance, and warrants to the original user that this product will be free of defects in workmanship and materials for one (1) year from the date of purchase.

This warranty does not cover wear and tear due to normal use, or damage to the product as the result of improper usage, neglect of care, alteration, accident or unauthorized repair.

If the product is found by PNI to be defective, PNI will repair or replace the product and return the product or its replacement to you at no charge, provided that you ship the product to PNI at your expense with a description of the defect and subject to the other conditions of this warranty. Should the product prove to be irreparable, PNI may substitute an equivalent product of the same or similar style and of a value not in excess of the original purchase price of your unit.

PNI warrants the repaired or replacement product to be free from defects in material and workmanship on the same terms as the product originally purchased.

This warranty will be void if the products, serial number or other identification marks have been defaced, damaged or removed. This warranty does not apply to the battery necessary to operate the product.

This warranty is extended to the original retail purchaser only and may not be transferred or assigned to subsequent owners. In order to validate your warranty, you must provide proof of purchase acceptable to PNI together with the product shipped for warranty repair/replacement.

Products returned to PNI must be pre-authorized by PNI with an RMA (return material authorization) number marked on the outside of the package. Please refer to the Service and Replacement section for PNI Corporation contact information.

10

FCC ID: OWF-KSS

This device complies with Part 15 of the FCC Rules. Operation is subject to the following two conditions:

- this device may not cause harmful interference, and
- this device must accept any interference received, including interference that may cause undesired operation.

Warning: Changes or modifications to this unit not expressly approved by the party responsible for compliance could void the user's authority to operate the equipment.

Note: This equipment has been tested and found to comply with the limits for a Class B digital device, pursuant to part 15 of the FCC Rules. These limits are designed to provide reasonable protection against harmful interference in a residential installation. This equipment generates, uses and can radiate radio frequency energy and, if not installed and used in accordance with the instructions, may cause harmful interference to radio communications. However, there is no guarantee that interference will not occur in a particular installation. If this equipment does cause harmful interference to radio or television reception, which can be determined by turning the equipment off and on, the user is encouraged to try to correct the interference by one or more of the following measures:

- Reorient or relocate the receiving antenna.
- Increase the separation between the equipment and receiver.
- Connect the equipment into an outlet on a circuit different from that to which the receiver is connected.
- Consult the dealer or an experienced radio/TV technician for help.